



भारतीय राष्ट्रीय राजमार्ग प्राधिकरण
(सड़क परिवहन और राजमार्ग मंत्रालय, भारत सरकार)
NATIONAL HIGHWAYS AUTHORITY OF INDIA
(Ministry of Road Transport & Highways, Government of India)
क्षेत्रीय कार्यालय - हैदराबाद
REGIONAL OFFICE - HYDERABAD

सत्यमेव जयते

प्रथम तल, नया भवन, भारतीय प्रशासनिक स्टाफ कॉलेज, रोड नं-3, बंजारा हिल्स, हैदराबाद-500 034, तेलंगाना.

First Floor, New Building, Administrative Staff College of India (ASCI), Road No. 3, Banjara Hills, Hyderabad - 500 034, Telangana.

टेली / Tele : 040 - 29562147 / 48 ई-मेल / Email : rohyderabad@nhai.org, nhairohyd@gmail.com



Notice Inviting Public Comments

NHAI/RO-HYD/25011/1/25/2021/Utility/**2338**

Dt.09.12.2021

Sub: NHAI - RO Hyderabad - PIU Hyderabad- Proposal for Permission for laying of Natural Gas Pipeline for a total length of 3.46 kM along National Highway from Km.54/300 to Km.55/700 (LHS) & Km.55/700 to Km.57/700 (RHS) through Open trench laying and HDD crossing at Km. 55/700 across the National Highway by HDD method on Hyderabad -Vijayawada section of NH-65 in the State of Telangana - Reg.

Ref: 1. PD, PIU Hyd letter no. NHAI/PIU-HYD/NH-65/Hyd-Vij/MEIL/2021/1550, Dt 20.10.2021

The Project Director, PIU, NHAI, Hyderabad vide letter cited above, has recommended the Proposal of M/s MEIL for grant of Permission for 'laying of Natural Gas Pipeline along National Highway from Km.54/300 to Km.55/700 (LHS) & Km.55/700 to Km.57/700 (RHS) through Open trench laying and HDD crossing at Km. 55/700 across the National Highway by HDD method on Hyderabad -Vijayawada section of NH-65 in the State of Telangana' for the approval of the Competent Authority

2. The proposal has been examined as per Ministry's Guidelines vide letter no. RW/NH-33044/29/2015/S&R(R) dated 22.11.2016.

3. In view of above, as per above Ministry's guidelines Para 4, public comments are hereby invited on the above proposal seeking claims and objections (on grounds of public inconvenience, safety and general public interest) within 30 days on public portal i.e. website of Ministry of Road Transport and Highways (www.morth.nic.in) in Form-A (copy enclosed) for "Accommodation of Public and Industrial Utility Services along and across National Highways".

Comment Inviting Authority

The Regional Officer,
National Highways Authority of India,
Regional Office: Hyderabad,
First Floor, New Building,
Administrative Staff College of India (ASCI),
College Park Campus, Road No.3,
Banjara Hills, Hyderabad - 500 034,
Telangana State,
Phone: 040-29562147, 040-29562148,
Email: rohyderabad@nhai.org, nhairohyd@gmail.com

Encls: Above Proposal

Yours faithfully,

(V. Nagamani)

Dy. General Manager Tech)

For Regional Officer-cum-

Highway Administrator, Hyderabad

To:

1. Senior Technical Director, NIC, Transport Bhawan, New Delhi- 110001 for uploading on Ministry's website.
2. Shri S.Manivasagam, Dy. GM (IT), NHAI HQs, New Delhi for uploading on NHAI website.

Copy to:- The Project Director, NHAI, PIU Hyderabad: for information

TYPICAL CROSS SECTION FOR ALONG THE ROAD
WITH OPEN TRENCH METHOD

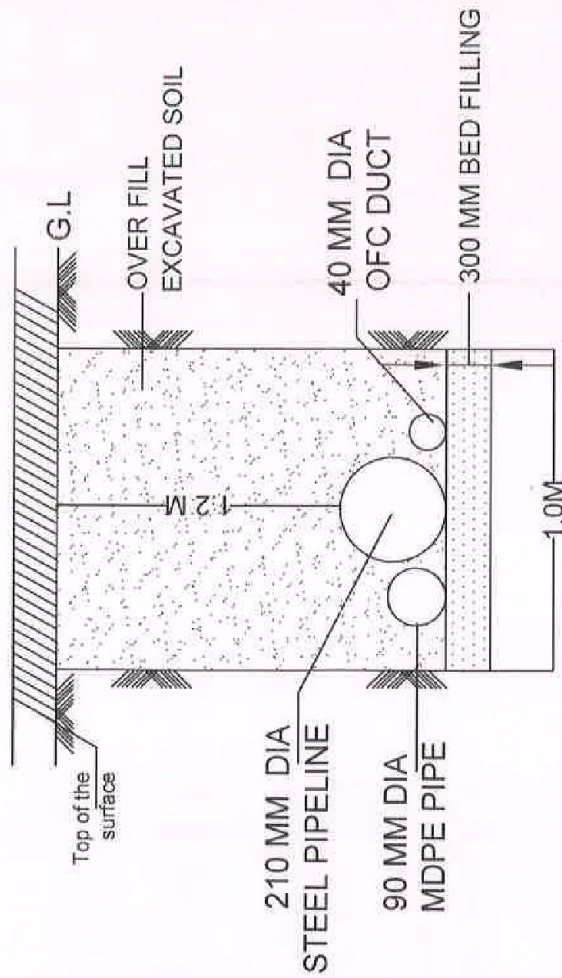

K. S. S. (S.E.)

✓

PROJECT DIRECTOR
NATIONAL HIGHWAYS AUTHORITY OF INDIA
PROJECT IMPLEMENTATION UNIT
HYDERABAD - 500 034.

TYPICAL CROSS SECTION FOR
HORIZONTAL DIRECTIONAL DRILLING(HDD METHOD)

(Note: If Culvert Depth more than 2.2 m, then as per site conditions depth will be maintain)

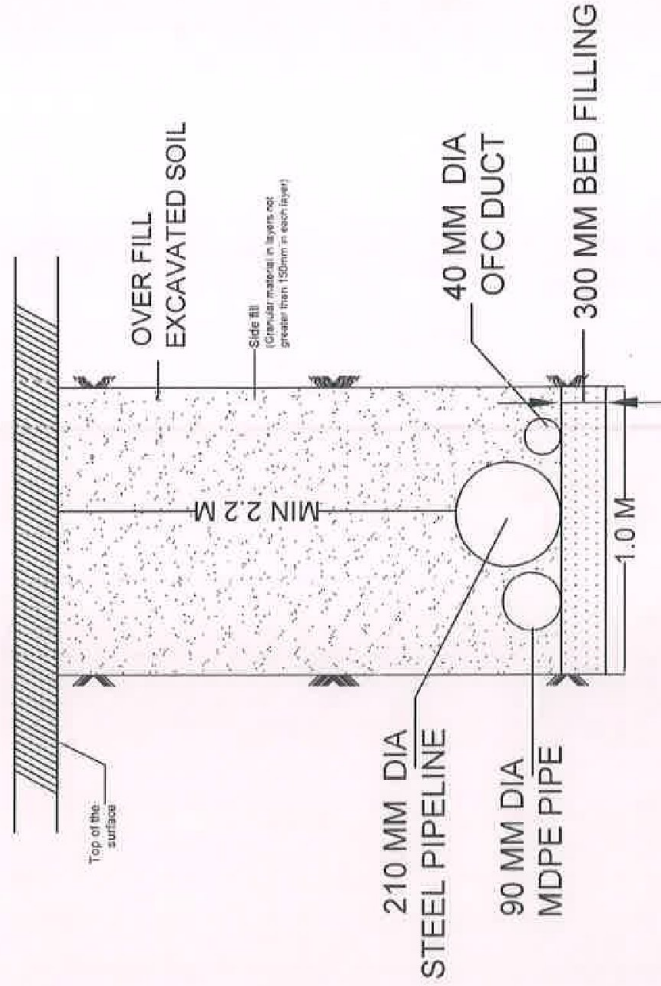

MEGHA ENGINEERING & INFRASTRUCTURES LIMITED
Sy. No. 265/A1 & 267/RU1, Sunkishala Village, Valligonda Mandal, Yadadri
Bhuvanagiri District-508112, Telangana State



FORM-A

Form for seeking claims and objections (on grounds of public inconvenience, safety and general public interest) on the application for Accommodation of Public and Industrial Utility Services along and across National Highways

Sub: NHAI - RO Hyderabad - PIU Hyderabad- Proposal for Permission for laying of Natural Gas Pipeline for a total length of 3.46 Km along National Highway from Km.54/300 to Km.55/700 (LHS) & Km.55/700 to Km.57/700 (RHS) through Open trench laying and HDD crossing at Km. 55/700 across the National Highway by HDD method on Hyderabad - Vijayawada section of NH-65 in the State of Telangana - **Reg.**

The claims and objections (on grounds of public inconvenience, safety and general public interest) by the general public needs to be given within 30 days of uploading the online application for comments

Sl. No	Item	Details
1	Name of the person who is desiring to give claims and objections (on grounds of public inconvenience, safety and general public interest)	
2	Address of the person	
3	Details of the application for Accommodation of Public and Industrial Utility Services along and across National Highways against which claims and objections are being given (name of applicant and other details like site address etc.)	
	a) Application No.	
	b) Name of applicant (who applied to Accommodation of Public and Industrial Utility Services along and across National Highways)	
	c) Details of Application	
4	The claims and objections (on grounds of public inconvenience, safety and general public interest)	

CHECK - LIST NH-65

Name of Work: Laying of Natural gas Pipeline under City Gas Distribution (CGD) project in Choutuppal Mandal along (NH-65) HYD-VJA Road b/w chainage nos 54/300 & 57/700 and crossing at 55/700

Sl. No.	Item	Information/ Status	Remarks
1	General information	Proposal for Permission for laying Natural Gas Pipe Line along (NH-65) HYD-VJA ,NHAI Road Choutuppal b/w chainage nos 54/300 & 57/700 and crossing at 55/700.	
1.1	Name and Address of the Applicant / Agency	H.O: M/sMegha Engineering& Infrastructures Ltd, S-2 T.I.E, Balanagar, Hyderabad-500037 Site ofc : Plot N0-3, Sy.No:598/AA, Veyond Hero ShowRoom, Yadadri Bhongir District, Pin-508126	
1.2	National Highway Number	NH -- 65	
1.3	State	Telangana	
1.4	Location	Hyd- Vja NHAI along NH-65 from Choutuppal to Lingoiguda	
1.5	(Chainage in km)	54/300 to 57/700 a) 54/300 to 55/700 (left side of increasing chainage in direction of Hyd- Vja) b) 55/700 (crossing NHAI) c) 55/700 to 57/700 (Right side of increasing chainage in direction of Hyd- Vja)	
1.6	Length in Metres	Along road :1.4 km (left side Hyd-Vja Nh-65)Along Road : 2.0 km (Right side Hyd-Vja	Total 3.4 km

K Bome.



Mgoc(T)

9D

1.7	Width of available ROW		
(a)	Left side from center line towards increasing Chainage / km direction.	30 mtrs	
(b)	Right side from center line towards increasing Chainage / km direction.	30 mtrs	
1.8	Proposal to lay underground gas pipeline	Natural gas Supply to Households, Industries, Commercial units	
(a)	Left side from center line towards increasing Chainage / km direction.	As per Drawing	
(b)	Right side from center line towards increasing Chainage / km direction.	As per Drawing	
1.9	Proposal to acquire land		
(a)	Left side from center line	NA	
(b)	Right side from center line	NA	
1.10	Whether proposal is in the same side where land is not to be acquired	yes	
	If not then where to lay the cable	----	
1.11	Details of already laid services, if any, along the proposed route	NOT APPLICABLE	
1.12	Number of existing lanes (2/4 6/8 lanes).	4 LANES 6 LANES	
1.13	Proposed Number of lanes (2 lane with paved shoulders/4/6/8 lanes)	4 LANES 6 LANES	
1.14	Service road existing or not		
	If yes then which side		
(a)	Left side from center line	YES	54/300 to in direction of Hyd-Vja
(b)	Right side from center line	YES	55/700 to in direction of Hyd - Vja
1.15	Proposed Service road		
(a)	Left side from center line	NA	
(b)	Right side from center line	NA	
1.16	Whether proposal to lay Gas Pipe line is after the service road or between the service road and main carriageway.	Proposed Gas Pipeline is at Extreme edge of ROW in between 27 mtrs-30 mtrs from Centerline	
1.17	The Permission for laying Gas Pipeline shall be considered approval/rejection Ministry Circulars.		

KRBonu.



(a)	Carrying of sewage/gas pipelines on highway bridges shall not be permitted as fumes/ gases pipes accelerate the process of corrosion or ma explosions, thus being much more injurious of water	NA	
(b)	Carrying of Gas pipelines on bridges shall discouraged .However , if gas supply seem to have no other viable alternative and the highway authority well in time before the bridge is finalized, they may permitted to pipeline on independent superstructure extended portion of piers and abutments in manner that in the final arrangement enough around the superstructure of the bridge for inspection and repairs etc	NA	
(c)	Cost of required extension of the as that of the supporting superstructure shall the agency –in charge of the utilities	NA	
(d)	Services are not being allowed parapet/any part of the bridges, safetyto be kept in view while permitting various bridge. Approvals are to be accorded in this concurrence of the Ministry's Project Engineers only	NA	
(e)	Whether carrying of sewage / gas pipeline has been proposed on the parapet/any part of the bridges. . If Yes, then mention the methodology proposed for the same.	NO	
1.18	If crossings of the road involved If Yes, it shall be either encased in pipes or through structure or conduits specially built for that purpose at the expanses of the agency owning the line	YES, Steel Casing will be provided at crossing 55/700	
(a)	Whether existing drainage structures are allowed to carry sewage / gas pipeline	NO	
(b)	Is it on a line normal to NH	TO BE LAID 1.5 MTS DEPTH FROM TOP OF ROAD Yes.	

K. Sharma.

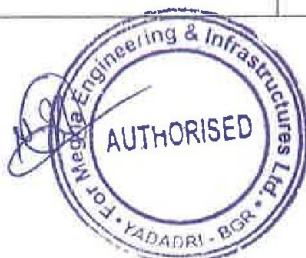

(c)	What is the distance of crossing the sewage / gas pipelines from the existing structures Crossings shall not be too near the existing structures on the National Highway, the minimum distance being 15 meter.	No existing structures near to crossing location	
(d)	The casing pipe (or conduit pipe in the case of electric cable) carrying the utility line shall be of steel, cast iron, or reinforced cement concrete and have adequate strength and be large enough to permit ready withdrawal of the carrier pipe / cable. Mention type of casing.	YES	Steel casing at crossing of Highway
(e)	Ends of the casing / conduit pipe shall be sealed from the outside, so that it does not act as a drainage path.	YES	
(f)	The casing/conduit pipe should, as minimum extend from drain to drain in cuts and toe of slope in the fills.	YES	
(g)	The top of the casing/conduit pipe should be at least. 1.2 meter below the surface of the road subject to being at least 0.3 m below the drain inverts. Mention the proposed details.	YES	
(h)	Mention the methodology proposed for crossing of road for the proposed Sewage/gas pipe line. Crossing shall be by boring method (HDD) [Trenchless Technology], specially, where the existing road pavement is of cement concrete or dense bituminous concrete type.	YES	Hdd method will be done at crossing, Methodology has been enclosed
(i)	The casing / conduit pipe shall be installed with an even bearing throughout its length and in such a manner as to prevent the formation of a waterway along it.	YES	P/L laid by using Open cut method along NHAI
2	Document / Drawings to be enclosed with the proposal		
2.1	Cross section showing the size of trench for open trenching method (Is it normal size of 1.2m deep x 0.3m wide) (i) Should not be greater than 60	YES	

K. B. Sharma



	<p>Cm wider than the outer diameter of the pipe.</p> <p>(ii) Located as close to the extreme edge of the right of way as possible but not less than 15 meter from the centre-lines of the nearest carriage way.</p> <p>(iii) Shall not be permitted to run along the National Highways when the road formation is situated in double cutting. Nor shall these be laid over the existing culverts and bridges.</p> <p>(iv) These should be so laid that their top is at least 0.6 meter below the ground level so as not to obstruct drainage of the road land.</p>		
2.2	Cross section showing the size of pit and location of cable for HDD method	YES	
2.3	Strip plan / Route Plan showing Gas pipe line, Chainage, width of ROW, distance of proposed Gas pipe line from the edged of ROW, important mile stone, intersections, cross drainage works etc.	YES	
2.4	Methodology for laying of Gas pipe line.	<u>YES</u>	P/L Will be laid by open cut method along NH, and HDD method at crossing
2.4.1	Open trenching method. (May be allowed in utility corridor only where pavement is neither cement concrete nor dense bituminous concrete type. If yes, what is the Methodology of refilling of trench	YES	
(a)	The trench width should be at least 30 cm, but not more than 60 cm wider than the outer diameter of the pipe.	YES	
(b)	For filling of the trench, (Bedding shall be to a depth of not less than 30 cm. It shall consist of granular material, free of lumps, clods and cobbles and graded to yield a firm	YES	

K. R. Ramu



	surface without sudden change in the bearing value. Unsuitable soil and rock edged should be excavated and replaced by selected material.		
(c)	The backfill shall be completed in two stages (i) side fill to the level of the top of the pipe and (ii) overfill to the bottom of the road crust.	YES	
(d)	The side-fill shall consist of granular material laid in 15 cm layers each consolidated by mechanical tampering and controlled addition of moisture to 95% of the Proctor's Density. Overfill shall be compacted to the same density as the material that had been removed. Consolidation by saturation or ponding will not be permitted.	YES	
(e)	The road crust shall be built to the same strength as the existing crust on either side of the trench. Care shall be taken to avoid the formation of a dip at the trench.	YES	
(f)	The excavation shall be protected by flagman, signs and barricades and red lights during night hours.	YES	
(g)	If required, a diversion shall be constructed at the expense of agency owning the utility line.	YES	
2.4.2	Horizontal Directional Drilling (HDD) Method	HDD at crossing NH 65	
2.4.3	Methodology for laying of Gas pipe Line through CD works and method of laying. In cases where the carrying of gas pipe line on the bridge becomes inescapable.	NA	
3	Draft License Agreement signed by two witnesses	Enclosed	
4	Performance Bank Guarantee in favor of NHAI has to be obtained @ Rs. 50/- per running meter (parallel to NH) and Rs. 1,00,000/- per crossing of NH for a period of one year, initially (extendable if required till satisfactory completion of work) as a security	YES (Undertaking given, Once the proposal is approved the BG will be furnished)	

K. B. M.

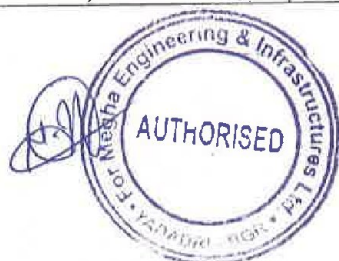

	for ensuring/making good the excavated trench for laying the Gas pipe line/ducts by proper filling and compaction, clearing debris/loose earth produced due to execution of trenching at least 50m away from the edge of the right of way. No payment shall be payable by the NHAI to the licensee for clearing debris/loose earth.		
4.1	Performance BG as per above is to be obtained.	YES	
4.2	Confirmation of BG has been obtained as per NHAI guidelines	To be obtained after approval of proposal	
5	Affidavit / Undertaking from the Applicant for the following is to be furnished		
5.1	Not to Damage to other utility, if damaged then to pay the losses either to NHAI or to the concerned agency.	YES Undertaking given	
5.2	For Renewal of Bank Guarantee.	YES Undertaking given	
5.3	For Confirming all standard condition of Ministry Circulars and NHAI's guideline.	YES Undertaking given	
5.4	For Shifting of Gas pipe line as and when required by NHAI at their own cost.	YES Undertaking given	
5.5	For shifting of Gas pipe line due to widening / widening of NH	YES Undertaking given	
5.6	For Indemnity against all damages and claims	YES Undertaking given	
5.7	For Traffic movement during laying of Gas pipe line to be managed by the applicant.	YES Undertaking given	
5.8	If any claim is raised by the Concessionaire then the same has to be paid by the applicant.	YES Undertaking given	
5.9	Prior approval of the NHAI shall be obtained before undertaking any work of installation, shifting or repairs, or alterations to the Gas pipe line/any other utility located	YES Undertaking given	

For Name.



	in the National highway right-of-ways.		
5.10	Expenditure, if any, incurred by NHAI for repairing any damage caused to the National Highway by the laying, maintenance of shifting of the Gas pipe line will be borne by the applicant agency owing the line.	YES Undertaking given	
5.11	If the NHAI considers it necessary in future to move the utility line for any work of improvement or repairs to the road, it will be carried out as desired by the NHAI at the cost of the agency owning the utility line within a reasonable time (not exceeding 60 days) of the intimation given.	YES Undertaking given	
5.12	Certificate from the applicant in the following format		
(i)	Laying of Gas pipe line will not have any deleterious effects on any of the bridge components and roadway safety for traffic.	YES Undertaking given	
(ii)	ii)"We do undertake that I/we will relocate service road/approach road/utilities at my/our own cost notwithstanding the permission	YES Undertaking given	
6	Who will sign the agreement on behalf of Gas pipe line agency	Site In-Charge, CGD Nalgonda Project, Megha Engineering & Infrastructures Ltd	
7	The Project Director, will submit the following Certificates		
7.1	Certificate for proposal for confirming of all standard condition issued vide Ministry of Road Transport and Highways Circular No. NH-III/P/66/76 dated 18/19.11.1976, RW/NH-III/P/66/76 dated 11.05.1982, RW/NH-11037/1/86-DOI (ii) dated 28.07.1993, RW/NH-11037/1/86/DOI dated 19.01.1995, RW/NH-34066/2/95/ S & R. dated	YES	

K. S. S. S.



	25.10.1999 and Circular No. RW/NH-34066/7/2003 S&R (B) dated 17.09.2003		
7.2	Certificate from PD in the following format		Enclosed
i)	i) "It is certified that any other location of the Gas Pipe line would be extremely difficult and unreasonable costly and the installation of Gas pipe line within ROW will not adversely affect the design, stability and traffic safety of the highway nor the likely future improvement such as widening of the carriageway, easing of curve etc".	YES	
ii)	for 6-lanning		
(a)	Where feasibility is available "I do certify that there will be no hindrance to proposed six-laning based on the feasibility report considering proposed structures at the said location".	NA	
(b)	In case feasibility report is not available "I do certify that sufficient ROW is available at site for accommodating proposed six-laning". Ltd	NA	
8	If NH section proposed to be taken up by NHAI on BOT basis - a clause is to be inserted in the agreement. "The permitted Highway on which Licensee has been granted the right to lay Gas Pipeline/duct has also been granted as a right of way to the concessionaire under the agreement	NA	
	Who will supervise the work of laying of Gas pipe line		
(a)	On behalf of the Applicant	Megha Engineering/ Inspection Engineer allotted by MEIL,	
(b)	On behalf of NHAI	NHAI/Independent Engineer	

JBlenu



10	Who will ensure that the defects in road portion after laying of Gas pipe line are corrected and if not corrected then what action will be taken.		
(a)	On behalf of the Applicant	Site In Charge	If not corrected, action will be taken against Site Incharge of Megha engineering & Infrastructures Ltd
(b)	On behalf of NHAI	NHAI/Independent Engineer	
11	Who will pay the claims for damages done/disruption in working of Concessionaire if asked by the Concessionaire		
(a)	On behalf of the Applicant	Site In-Charge, CGD Nalgonda Project, Megha Engineering & Infrastructures Ltd	
12	A certificate from PD that he will enter the proposed permission in the register of records of the permissions in the prescribed proforma (copy enclosed)	YES	
13	If any previous approval is accorded for laying of underground Gas Pipe line then Photocopy of register of records of permissions accorded as maintained by PD then copy be enclosed.	NO	

 Site-Incharge,
 CGD Nalgonda Project,
 Megha engineering & Infrastructures Ltd

PROJECT DIRECTOR
 NHAI

K. Sharma
 (S.E)

 MGT (T)

 PD

1

PROPOSAL FOR LAYING OF GAS PIPE LINE OF M/s. MEGHA ENGINEERING & INFRASTRUCTURES LIMITED.
from KM.54/300 to KM. 55/700 (LHS) and from Km. 55/700 to 57/700 (RHS) and crossing at Km. 55/700, On NH-65 Of HYDERABAD-VIJAYAWADA SECTION.

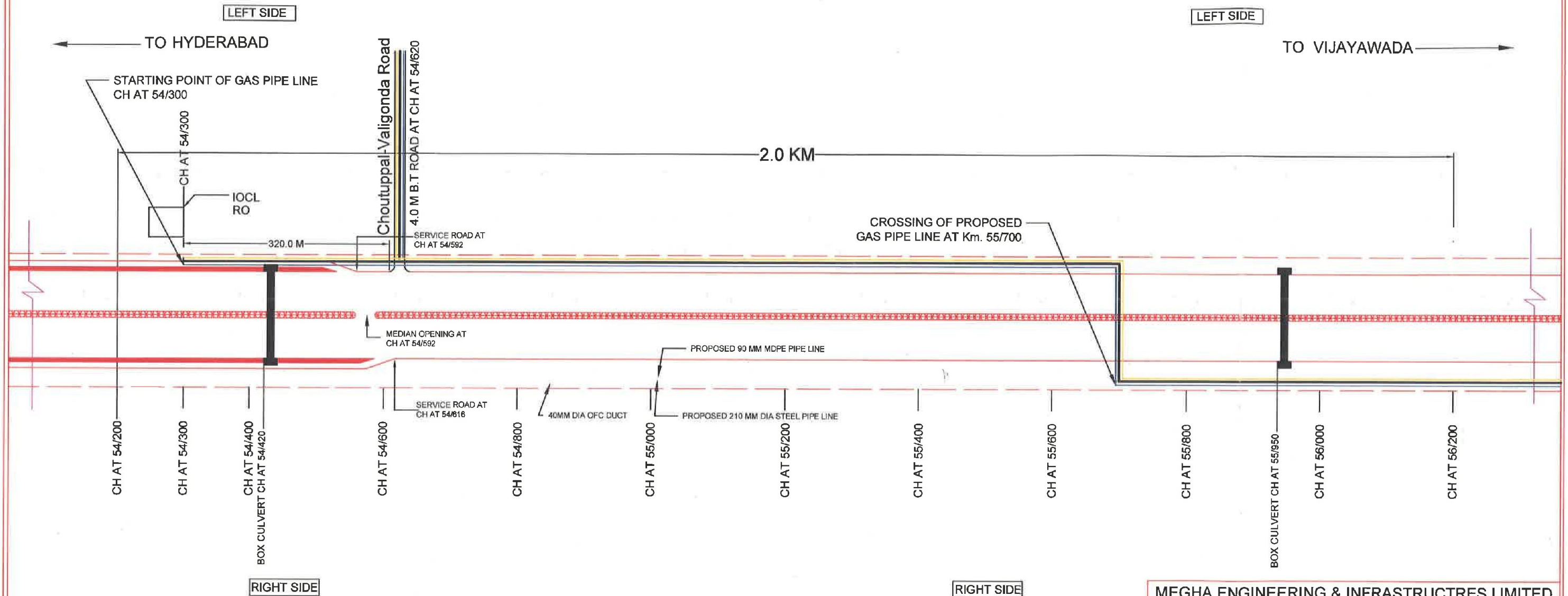

K. Bhanu
(S.E)

72

[Signature]
PROJECT DIRECTOR
NATIONAL HIGHWAYS AUTHORITY OF INDIA
PROJECT IMPLEMENTATION UNIT
HYDERABAD - 500 034.

TOPO PLAN

MEGHA ENGINEERING & INFRASTRUCTURES LIMITED

Sy. No. 265/A1 & 267/RU1, Sunkishala Village, Valigonda Mandal, Yadadri
Bhuvanagiri District-508112, Telangana State



2

PROPOSAL FOR LAYING OF GAS PIPE LINE OF M/s. MEGHA ENGINEERING & INFRASTRUCTRES LIMITED.
from KM.54/300 to KM. 55/700 (LHS) and from Km. 55/700 to 57/700 (RHS) and crossing at Km. 55/700, On NH-65 Of HYDERABAD-VIJAYAWADA SECTION.

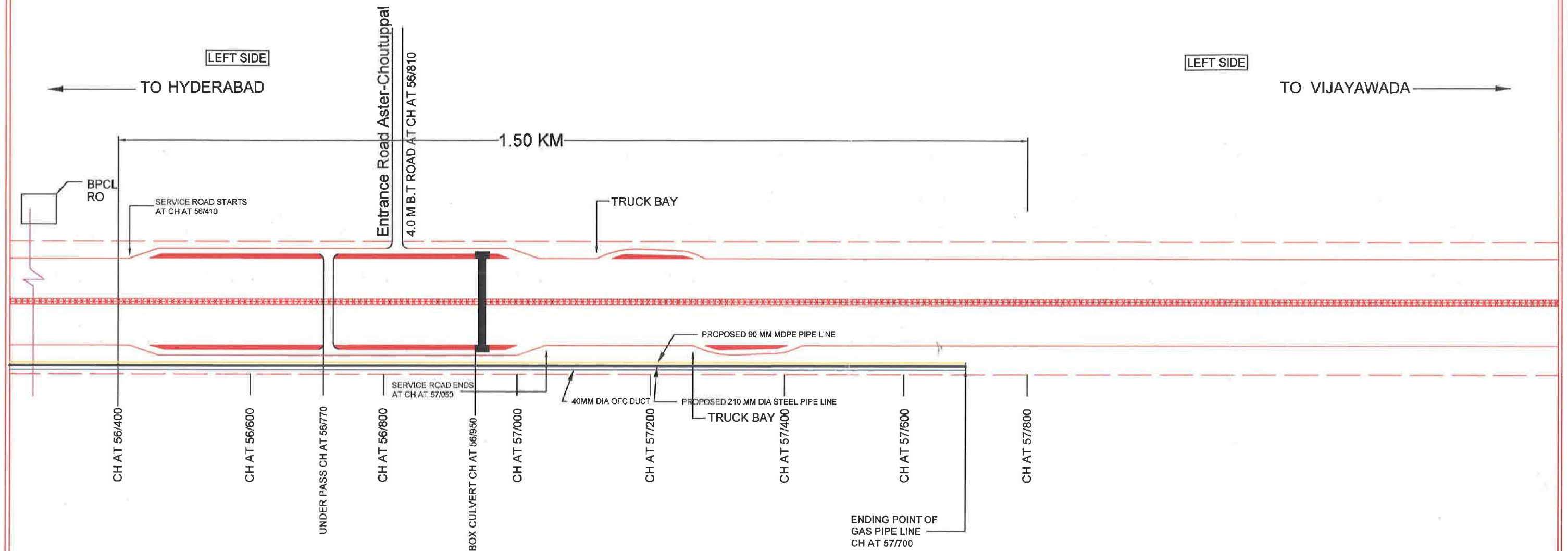

Krishanu
(S.E)

[Signature]

PROJECT DIRECTOR
NATIONAL HIGHWAYS AUTHORITY OF INDIA
PROJECT IMPLEMENTATION UNIT
HYDERABAD - 500 034.

TOPO PLAN

MEGHA ENGINEERING & INFRASTRUCTRES LIMITED
Sy. No. 265/A1 & 267/RU1, Sunkishala Village, Valigonda Mandal, Yadadri
Bhuvanagiri District-508112, Telangana State

